



**BENJAMIN
STEVENS.**
estate agents



The Birches, Bushey WD23 4TW

£2,750 PCM

Benjamin Stevens are proud to present this spacious four bedroom house located on a quiet cul-de-sac road.

The property is ideally located close to Bushey Meadows Secondary School (0.3 miles).

The property comprises of four double bedrooms, Two bathrooms (One en-suite), Two reception rooms, a large spacious kitchen diner, a private rear garden and a driveway.

Please call 020 3271 0111 to book a viewing..

The Birches, Bushey WD23 4TW

Reception 1 8'2 x 13'1 (2.49m x 3.99m)



A bright reception room with double doors leading to the hallway

Reception 2 7'7 x 13'3 (2.31m x 4.04m)



A bright reception room leading to Utility room

Kitchen/Diner 19'11 x 18'3 (6.07m x 5.56m)



A bright and very spacious kitchen diner with plenty of light and double doors leading to the rear garden and a side door leading to the side alley

Master Bedroom 11'11 x 11'9 (3.63m x 3.58m)



A bright a spacious bedroom with built in wardrobes and an en-suite bathroom

Bedroom 2 11'7 x 11'4 (3.53m x 3.45m)



A bright double bedroom with a triple door wardrobe

Bedroom 3 8'2 x 13'1 (2.49m x 3.99m)



A bright double bedroom with wardrobes and double glazing windows.

The Birches, Bushey WD23 4TW

Bedroom 4 7'9 x 11'10 (2.36m x 3.61m)



Bedroom with wardrobes and double glazing windows

Rear Garden



Rear Garden with shed and lawn area

Front of House



GROUND FLOOR 678.76 sq. ft.
(63.06 sq. m.)

1ST FLOOR 671.78 sq. ft.
(62.41 sq. m.)

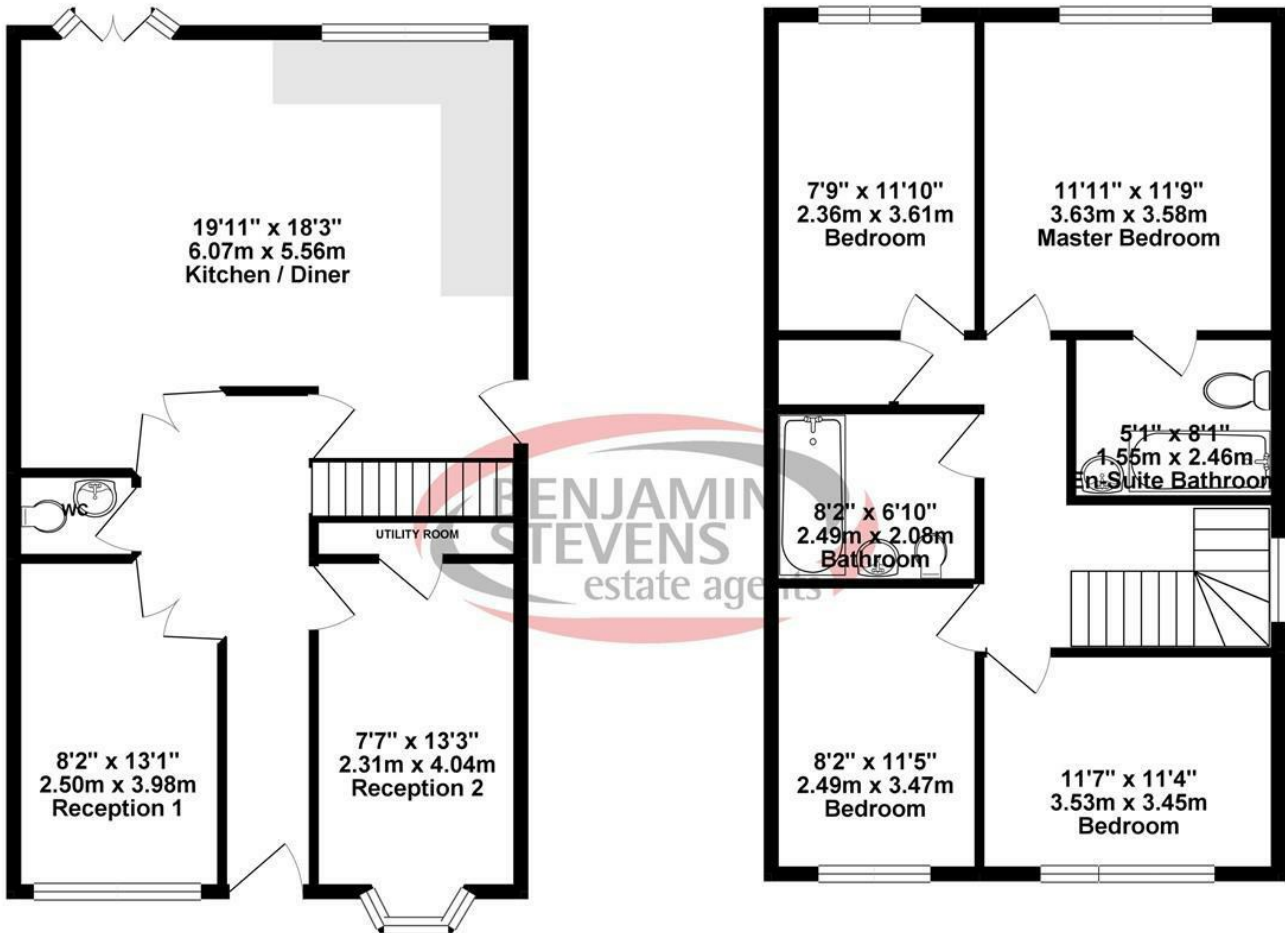

TOTAL FLOOR AREA : 1350.54 sq. ft. (125.47 sq. m.) approx.

Whilst every attempt has been made to ensure the accuracy of the floorplan contained here, measurements of doors, windows, rooms and any other items are approximate and no responsibility is taken for any error, omission or mis-statement. This plan is for illustrative purposes only and should be used as such by any prospective purchaser. The services, systems and appliances shown have not been tested and no guarantee as to their operability or efficiency can be given.
Made with Metropix ©2019

